

# Hills®

## The Garden Pressure Sprayer

Product Manual

4, 5, 7 & 8  
litre models



Legendary Australian Ingenuity  
Ergonomic handle with lockable continuous flow feature  
Safety valve prevents manual over pumping  
Bottle is UV stabilised for Australian Conditions

## Warning

This sprayer is designed for domestic use only with water based garden chemicals. Not to be used for any other purpose. To be used by adults only.

**Important:** under normal use and conditions the sprayer bottle has a maximum life of five (5) years after purchase date. The purchase date, place of purchase and product number should be recorded in this Product Manual.

## Contents

Refer to diagram on page 5 for parts listed.

- 1 x sprayer bottle assembly
- 1 x internal pump assembly
- 1 x lance assembly with nozzle
- 1 x product manual
- 1 x strip nozzle
- 1 x I.D. Tag
- 1 x I.D. Tag insert sheet

## Spare Parts

**0100710** – Nozzle and Lance Kit

**0100711** – Service Kit

Includes: bucket washer, pump valve, bucket support washer, valve plunger, valve cap seal, safety valve and O ring.

## Accessories

**0100709** – Cone Spray Shield and Cup

**0100708** – Lawn Edger Shield

Two nozzles are included. One is for cone spray pattern and one is for strip spray pattern. Choose the one suitable for your particular spraying application.

Please retain this Product Manual. Record the following information for future reference.

Product Number (printed on carton): \_\_\_\_\_

Date of purchase: \_\_\_\_\_

Name and location of store: \_\_\_\_\_

\_\_\_\_\_  
\_\_\_\_\_



Designed and tested under a  
Quality System that meets Hills  
demanding quality specifications.

Made in China

## Safety Instructions

**Caution:** contents under pressure. Read this before operating.

- Release pressure from the bottle before refilling or replacing parts. This is done by slowly pulling up the safety valve and holding until all air has been released. Then unscrew the container cap. **Note:** some remaining air may be expelled.
- Inspect the condition of all fittings before each use. Do not attempt to use your sprayer with worn or damaged parts. These parts should be replaced. Refer to spare parts list.
- Safety valve operation: over pumping will cause the safety valve to open and release excess pressure. It will close when safe operating pressure is reached.
- Safety valve test: fill the bottle to the maximum filling level with clean water. Pressurise by pumping a few times. Once it has reached full pressure the valve should lift, allowing the red indicator to become visible and air to escape. If this does not happen, replace the safety valve.
- Your sprayer is made from many different types of plastic materials, and although the liquid you may wish to use is packed in a plastic container, it is not guaranteed that it will not damage your sprayer. Your sprayer is designed for use with a broad range of domestic water based herbicides, fungicides, insecticides and fertilisers. Do not use other types of chemicals as they may be detrimental to the safe operation of your sprayer.
- Follow chemical suppliers on-pack instructions.

**Do's**

- ✓ Release pressure before filling/servicing
- ✓ Release pressure and clean after use
- ✓ Wear safety goggles and gloves
- ✓ Wear protective clothing and mask
- ✓ Spray water soluble chemicals
- ✓ Ensure adequate ventilation
- ✓ Wash hands and face after use
- ✓ Store away from sunlight
- ✓ Hand tighten fittings only
- ✓ Rinse inside of bottle before use
- ✓ Maintain and service regularly
- ✓ Read and understand chemical manufacturers' safety directions

**Dont's**

- ✗ Spray flammable liquids or solvents
- ✗ Leave full bottle unattended
- ✗ Eat, drink or smoke when spraying
- ✗ Direct spray on humans or animals
- ✗ Spray in windy conditions
- ✗ Spray in confined spaces
- ✗ Leave within reach of children
- ✗ Over fill the bottle
- ✗ Over pressurise
- ✗ Stand sprayer near naked flame or hot surfaces
- ✗ Tighten fittings with pliers etc.
- ✗ Allow children to use as a toy
- ✗ Modify bottle or safety valve

### Internal pump assembly

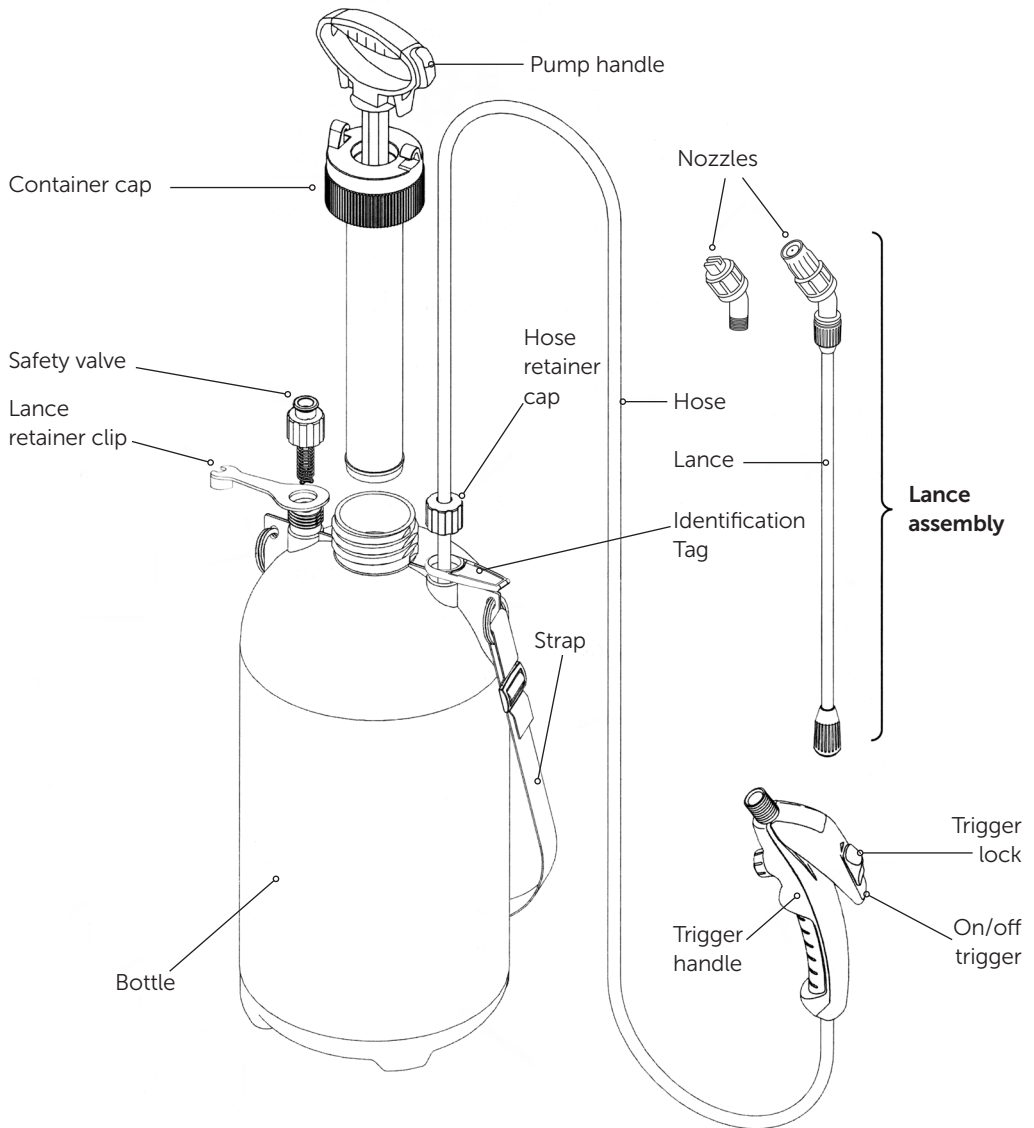

**Important:** ensure all caps, safety valve, hose and lance assembly are firmly tightened.

## Operating Instructions

**Important:** Rinse the inside of the bottle with cold water before use. Before using with any chemicals it is advisable to familiarise yourself with the sprayer by trialing it first with water only. Thick mixtures can clog the spray nozzle. Mixtures of this kind should be strained to prevent blockages. Wash the bottle, attachments and your hands thoroughly after use.

### Before Use

- Remove the internal pump assembly by unscrewing the container cap. Fill liquid to the required level. **Do not exceed the "MAXIMUM FILLING" level.**
- Insert internal pump assembly and tighten container cap firmly by hand.
- Make sure the safety valve and hose retainer cap are tight to prevent air escaping.
- Firmly screw the lance assembly to the trigger handle.

### Operation

- Pump the sprayer until the safety valve starts to open and vent. Your sprayer is designed to operate at 40 P.S.I. (275 kpa). You will notice that when the sprayer is at full pressure the safety valve will lift and a red indicator becomes visible.
- Pump periodically to maintain constant spraying pressure.
- Lock pump handle into container cap. This allows you to carry the sprayer. You can also use the strap supplied.
- Start spraying by pressing the on/off trigger. The trigger is equipped with a lock for continuous spraying. To lock, press the trigger and slide the trigger lock forward. To unlock, slide the trigger lock back and release the on/off trigger.
- Choose the type of nozzle according to your spraying application. Turn the nozzle to obtain the desired spray pattern.

### After Use

- When you have finished, release pressure from the bottle by slowly pulling up the safety valve and holding until all air has been released. **Do not release pressure by unscrewing the container cap.**
- After you have ensured the sprayer contains no pressure, unscrew the container cap and carefully dispose of any liquid left inside the bottle. To clean your sprayer, rinse the bottle, then fill the bottle with clean water to the 2L level, pressurise your sprayer and allow it to empty.

### Storage

- Make sure that the sprayer is not pressurised and contains no liquid. Do not store in direct sunlight and store out of reach of children. Refer to detailed safety instructions on page 3 and 4.

## Maintenance Advice

Over a period of time some chemicals can leave a build up of residue which normal cleaning will not remove. This build up can collect around the seals in your sprayer, which may eventually stop the sprayer from working. To overcome this problem we recommend that the bottle be half filled with hot (not boiling) water. Pressurise and spray for a few minutes. The hot water should dissolve any built up residue allowing your sprayer to operate normally.

**Important:** For safety, do not leave the sprayer unattended during this operation.

**Important:** If for some reason your sprayer needs to be returned for warranty purposes, PLEASE wash it out thoroughly to protect our service technicians from exposure to unknown substances.

## Strip Spray

Your sprayer comes with an additional strip spray nozzle attachment to aid in controlled spraying.

- To fit strip spray, remove the green nozzle from the grey attachment cap. Refer to **Fig. 1 and 2**.
- Remove the nozzle from cap. Refer to **Fig. 3**.
- Re-assemble the two green halves of nozzle and store safely.
- Place strip spray nozzle into rear of attachment cap along with filter. Refer to **Fig. 4**.
- Replace assembly onto end of nozzle elbow. Refer to **Fig. 5**.

Fig. 1

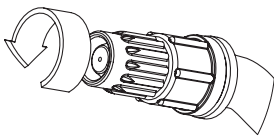

Fig. 2

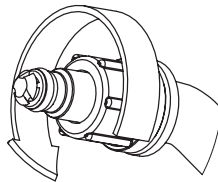

Fig. 3

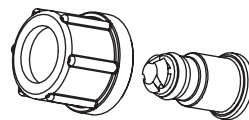

Fig. 4

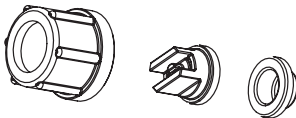
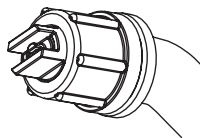

Fig. 5





## Substance Identification Tag

- Your Hills Garden Sprayer comes with a substance identification tag allowing you to quickly and easily identify what substance is inside your sprayer.
- For your convenience the tag comes with a sheet of pre-printed inserts that display common spraying substances.
- The sheet comes with a number of blank inserts that allow you create your own personalised tags. **Note:** Use a permanent marker when writing on the inserts to prevent writing coming off.

## To Fit Inserts:

- Open the folding lid by unclipping the two side located snaps.
- Fit required insert with the text facing upwards (towards folding lid).
- Snap folding lid back into closed position to secure.

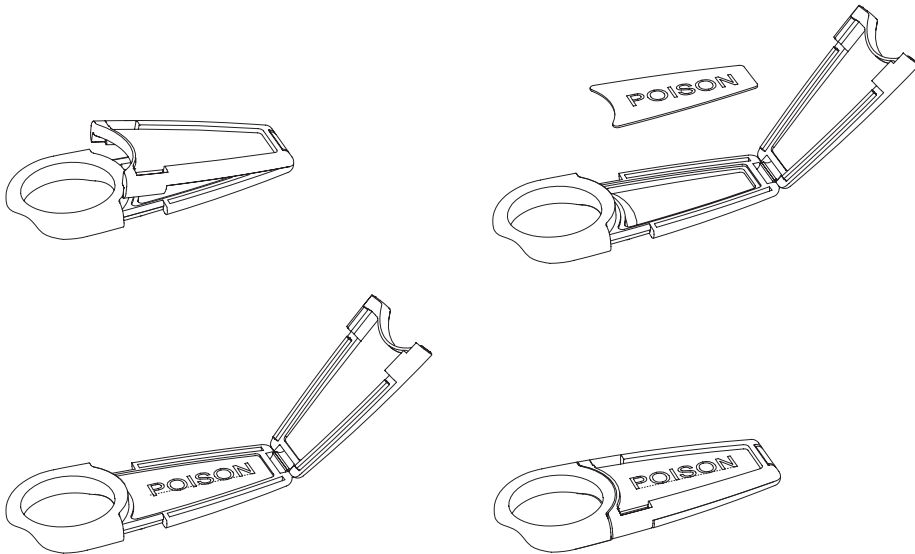

In addition to all rights and remedies to which you may be entitled under the Australian Competition and Consumer Act 2010 (Cth) or the New Zealand Consumer Guarantees Act (1993) and any other relevant legislation, Hills Home Living or Hydrox Brands Limited warrants the Garden Sprayer to be free from defects in materials or workmanship for 3 years from the date of purchase.

In the event of a claim, you must take the product with proof of purchase and an explanation of the fault to the place of purchase or contact Hills and provide your proof of purchase. All costs associated with the return of the good (and other expenses incurred in claiming under this warranty) are your responsibility. We will, at our option, either repair or replace the product.

Hills' liability under this warranty is subject to Hills being satisfied that a defect was caused by defective workmanship or materials and was not caused by or substantially contributed to by other factors including (but not limited to) maintenance or repair, adjustments or modifications of the product in a manner not recommended by the manufacturers or any neglect, misuse or excessive use.

In Australia, our goods come with guarantees that cannot be excluded under the Australian Consumer Law. You are entitled to a replacement or refund for a major failure and for compensation for any other reasonably foreseeable loss or damage. You are also entitled to have the goods repaired or replaced if the goods fail to be of acceptable quality and the failure does not amount to a major failure.

This warranty is provided by Hills Home Living, 3 City View Road, Pennant Hills NSW 2120, Ph 1300 300 564 for goods purchased within Australia. For goods purchased within New Zealand, this warranty is provided by Hydrox Brands Limited, 60 Kerrs Road, Wiri 2104, New Zealand, Ph 0800 021 027.

## Hills Contacts

We are committed to providing you with complete customer satisfaction. If you have any questions or comments about our products or services please contact your nearest Customer Service Centre during their local business hours:

### **Australia**

1300 300 564

[hhl.enquiries@woolworths.com.au](mailto:hhl.enquiries@woolworths.com.au)

### **New Zealand**

0800 021 027

[hhl@progressive.co.nz](mailto:hhl@progressive.co.nz)

### **Hills Websites**

**[hillshome.com.au](http://hillshome.com.au)**

Hills Home Living

**[hillshome.com.au/need-help/](http://hillshome.com.au/need-help/)**

Hills Consumer Advice



**Hills Home Living**  
A.B.N. 92 138 990 584  
Issue October 2015  
HH2358a

